

Product

KEBS 0560



KEBS-0560 is a crimping tool for endsleeves according to DIN 46228, 0.5 - 6 mm²/AWG 22-10, front feeded, Trapez-Crimp.

- High strength, through hardened alloy steel construction
- Unique mechanism significantly reduces hand force requirement over competing crimping tools
- Versatile and easy to customize for right hand or left hand users.
- Non-slip pad holds tool in place when leveraging on a work surface
- Full cycle crimp mechanism to ensure consistent, reliable crimp
- Ratchet release mechanism to clear miscrimps and obstructions
- Precision eccentric adjustment for consistent performance and ability to calibrate
- Hole in handle allows attachment of safety strap
- Each tool has a unique serial number for traceability

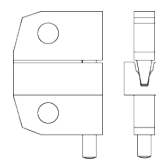

Die profile



Crimp profile

TECHNICAL DATA

Length: 220 mm/8.66"

Width: 22.5 mm/0.87"

Height: 72 mm/2.83"

Weight: 430 gr/0.95 lb

Wire size: 0.5-6 mm² / AWG 22-AWG 10

Crimp dimensions mm/mm²:
0,5 - 6 mm²

Crimp dimensions inch/AWG:
AWG 22 - AWG 10

Connector: Endsleeves

Description: For endsleve connectors, both uninsulated and insulated.

Life span, cycles: 50,000