



DEHNventil®modular DV M TT 255 (FM)

- DE Einbauanleitung
- GB Installation instructions
- IT Istruzioni di montaggio
- FR Instructions de montage
- NL Montagehandleiding
- ES Instrucciones de montaje
- PT Instruções de montagem
- DK Monteringsvejledning
- SE Monteringsanvisning
- FI Asennusohje
- GR Οδηγίες συναρμολόγησης
- PL Instrukcja montażu
- CZ Návod k montáži
- TR Montaj kılavuzu
- RU Инструкция по монтажу
- CN 安装说明
- HU Szerelési útmutató
- JP 設置説明書



I+II IEC 61643-11...
1+2 EN 61643-11...

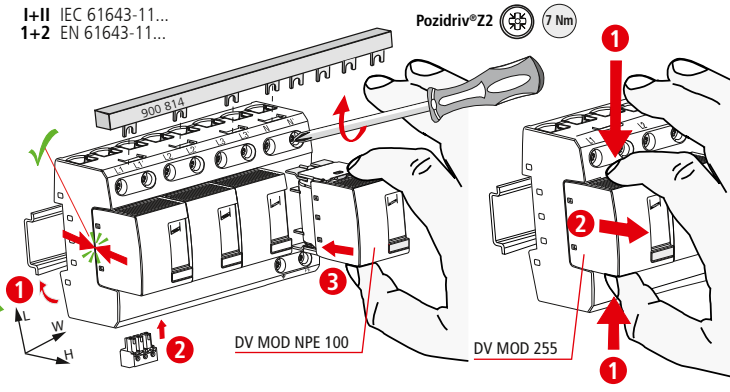

2) TT, TN-S (3+1)

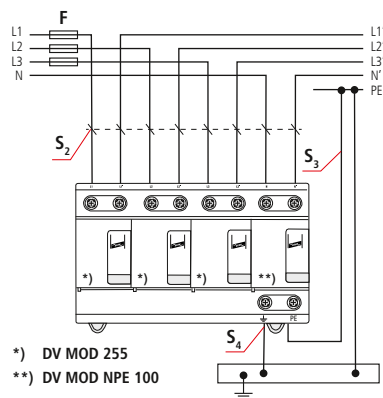

*) DV MOD 255
**) DV MOD NPE 100

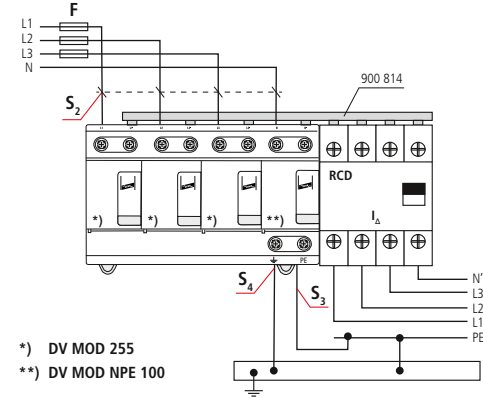

*) DV MOD 255
**) DV MOD NPE 100

DEHNventil modular DV M TT 255 (FM)	
F	$F \leq 125 \text{ A gG}$
F	$F > 125 \text{ A gG}$

F A gG	S ₂ / mm ²	S ₃ / mm ²	S ₄ / mm ²
25	10	16	16
35	10	16	16
40	10	16	16
50	10	16	16
63	10	16	16
80	16	16	16
100	25	16	16
125	35	16	16

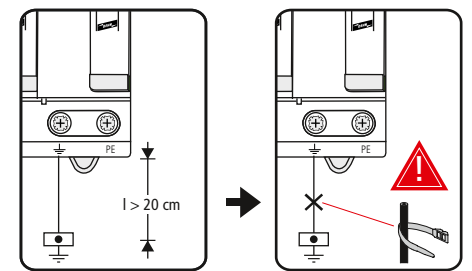

3) TT, TN-S (3+1)

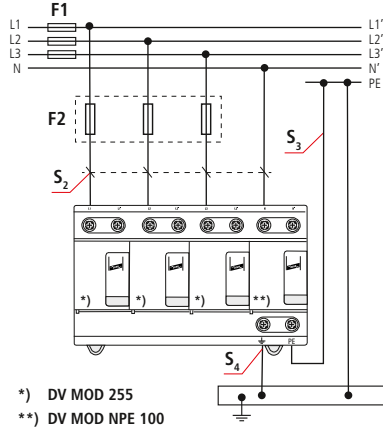

*) DV MOD 255
**) DV MOD NPE 100

DEHNventil modular DV M TT 255 (FM)	
F1	$F1 > 315 \text{ A gG}$
F1	$F2 \leq 315 \text{ A gG}$
F2	$F1 \leq 315 \text{ A gG}$
F2	$F2 > 315 \text{ A gG}$

$I_k \leq 100 \text{ kA}_{rms}$

F1 A gG	S ₂ / mm ²	S ₃ / mm ²	S ₄ / mm ²	F2 A gG
25	10	16	16	---
35	10	16	16	---
40	10	16	16	---
50	10	16	16	---
63	10	16	16	---
80	10	16	16	---
100	16	16	16	---
125	16	16	16	---
160	25	25	25	---
200	35	35	25	---
250	35	35	25	---
315	50	50	25	---
>315	50	50	25	315

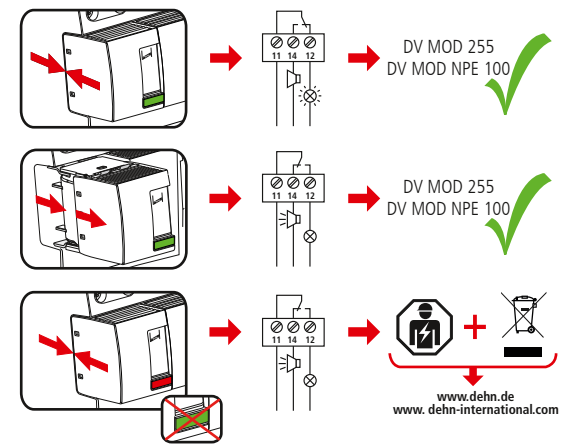

DEHNventil modular DV M TT 255 FM	
U_n / I_n	AC: 250 V / 0.5 A
	DC: 250 V / 0.1 A 125 V / 0.2 A 75 V / 0.5 A
max. 1.5 mm ²	

