

LFD-200

LIVE FIBER DETECTOR



Allows you to detect traffic and measure signals anywhere on singlemode fibers without having to disconnect them.

KEY FEATURES

No need to open fiber for identification

Hands-free operation via Hold button

Three interchangeable adapter heads

Extended range model: 23 to -50 dBm

SPEC SHEET



Assessing
Next-Gen Networks

NO-DISCONNECTION LIVE FIBER DETECTION

The LFD-200 Live Fiber Detector allows you to detect traffic and measure signals anywhere on singlemode fibers without having to disconnect them. It also lets you check for signal presence before rerouting or maintenance, perform continuity tests and verify cable labeling. Based on non-destructive macrobending technology, the LFD-200 doesn't disrupt traffic, damage or overstress the fiber, enabling efficient, accurate and reliable data acquisition.

Simple Testing of Multiple Fiber Types

EXFO's LFD-200 is the only instrument of its kind on the market that comes with a choice of three built-in, interchangeable adapter heads, making it an all-in-one solution for live fiber detection. The handle's storage compartment holds the extra adapter heads for simple conversion and easy testing of various fiber types.

The LFD-200 also features a unique Hold button that enables hands-free operation. Just slide the button up and over to lock it in place. You are now free to operate your setup.



Adapter heads compartment (door open)



Ball allowing the adjustment of the compartment door

Adapter heads compartment (door closed)

COMPLETE DIAGNOSIS. FAST.

Simply clamp the LFD-200 onto a fiber, listen for a beep indicating the presence of traffic, then view a complete status report on the multifunction LED display:

- › Signal presence or absence (live or dark fiber)
- › Signal type (customer traffic, continuous or modulated test signal at 270 Hz, 1 kHz or 2 kHz)
- › Signal direction
- › Core power within 2 dB (typical)

| LFD-200 SERIES: MODELS AND FEATURES | | | |
|-------------------------------------|------------------------|------------------------|------------------------|
| | LFD-201 | LFD-202 | LFD-202E |
| Core power display | | √ | √ |
| Maximum power range (dBm) | 0 to -40 | 0 to -40 | 23 to -50 |
| Over-range indicator | | √ | √ |
| Fiber type | Single fiber | Single fiber | Single fiber |
| Fiber heads (included) | 3 mm 900 250/RIB | 3 mm 900 250/RIB | 3 mm 900 250/RIB |
| Optional 2 mm head | √ | √ | √ |
| Optional 1.6 mm head | | | √ |

Standard Accessories (Interchangeable Heads)

LFD-201, LFD-202 and LFD-202E

3 mm

Extra head for jacketed fiber (3 mm)

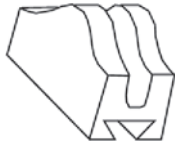

900

Extra head for jacketed fiber (900 mm)

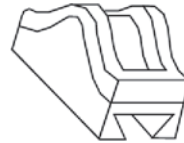

250/RIB

Extra head for coated fiber (250 μm) and ribbon fiber



SPECIFICATIONS

LFD-201, LFD-202 and LFD-202E

Optical Characteristics, Typical

| | |
|-----------------------|--|
| Optical tone receiver | 270 Hz, 1 kHz, 2 kHz |
| Detection technique | Non-destructive macrobending |
| Loss | < 0.6 dB at 1310 nm |
| Spectral response | 800 nm to 1650 nm |
| Minimum fiber slack | 1.2 cm (1/2 in) required for detection |

Core Power Detection, Typical^a

| | |
|----------|-------------------|
| LFD-201 | 0 dBm to -40 dBm |
| LFD-202 | 0 dBm to -40 dBm |
| LFD-202E | 23 dBm to -50 dBm |

Fiber Compatibility

| | |
|-------------------------|---------------------------------|
| Dual window, singlemode | 8 µm to 10 µm core diameter |
| Coating diameter | 250 µm diameter |
| Coating | High refractive index, acrylate |

GENERAL SPECIFICATIONS

| | | |
|------------------|---|--------------------|
| Size (H x W x D) | 236 mm x 30 mm x 32 mm (9 5/16 in x 1 3/16 in x 1 1/4 in) | |
| Weight | 0.3 kg | (0.6 lb) |
| Battery | Standard 9 V alkaline battery | |
| Battery life | Approx. 5000 readings | |
| Temperature | | |
| Operating | -20 °C to 50 °C | (-4 °F to 122 °F) |
| Storage | -40 °C to 60 °C | (-40 °F to 140 °F) |
| Humidity | 0 % to 90 % non-condensing at 35 °C | |

OPTIONAL ACCESSORIES

Optional interchangeable 2 mm head

Optional interchangeable 1.6 mm head

Includes: LFD-200 carrying case, three interchangeable adapter heads, user guide, 9 V alkaline battery and Certificate of Compliance.

Note

a. At 1550 nm.

ORDERING INFORMATION

LFD-20X-X

Live fiber detector

LFD-201 = Standard live fiber detector without core power reading display
 LFD-202 = Live fiber detector with core power reading display
 LFD-202E = Core power reading display (23 dBm to -50 dBm)

Additional heads

00 = No additional heads
 01 = With 2 mm interchangeable head
 02 = With 1.6 mm interchangeable head
 03 = With 2 mm and 1.6 mm interchangeable heads

Example: LFD-201-01

EXFO Corporate Headquarters > 400 Godin Avenue, Quebec City (Quebec) G1M 2K2 CANADA | Tel.: +1 418 683-0211 | Fax: +1 418 683-2170 | info@EXFO.com

Toll-free: +1 800 663-3936 (USA and Canada) | www.EXFO.com

| | | | |
|------------------------|---|---------------------------|-------------------------|
| EXFO America | 3400 Waterview Parkway, Suite 100 Richardson, TX 75080 USA | Tel.: +1 972 761-9271 | Fax: +1 972 761-9067 |
| EXFO Asia | 100 Beach Road, #22-01/03 Shaw Tower SINGAPORE 189702 | Tel.: +65 6333 8241 | Fax: +65 6333 8242 |
| EXFO China | 36 North, 3 rd Ring Road East, Dongcheng District Room 1207, Tower C, Global Trade Center Beijing 100013 P. R. CHINA | Tel.: + 86 10 5825 7755 | Fax: +86 10 5825 7722 |
| EXFO Europe | Omega Enterprise Park, Electron Way Chandlers Ford, Hampshire S053 4SE ENGLAND | Tel.: +44 23 8024 6810 | Fax: +44 23 8024 6801 |
| EXFO NetHawk | Elektronikkatie 2 FI-90590 Oulu, FINLAND | Tel.: +358 (0)403 010 300 | Fax: +358 (0)8 564 5203 |
| EXFO Service Assurance | 270 Billerica Road Chelmsford, MA 01824 USA | Tel.: +1 978 367-5600 | Fax: +1 978 367-5700 |

EXFO is certified ISO 9001 and attests to the quality of these products. This device complies with Part 15 of the FCC Rules. Operation is subject to the following two conditions: (1) this device may not cause harmful interference, and (2) this device must accept any interference received, including interference that may cause undesired operation. EXFO has made every effort to ensure that the information contained in this specification sheet is accurate. However, we accept no responsibility for any errors or omissions, and we reserve the right to modify design, characteristics and products at any time without obligation. Units of measurement in this document conform to SI standards and practices. In addition, all of EXFO's manufactured products are compliant with the European Union's WEEE directive. For more information, please visit www.EXFO.com/recycle. Contact EXFO for prices and availability or to obtain the phone number of your local EXFO distributor.

For the most recent version of this spec sheet, please go to the EXFO website at www.EXFO.com/specs.

In case of discrepancy, the Web version takes precedence over any printed literature.